



For sale in Calpe luxury villa with sea views

CALPE - CALP - REF. V-116



MORAGUESPONS
MEDITERRANEAN HOUSES

Luxury villa with panoramic sea views. 4 level constant accommodation. On the ground floor there is a separate 2 bedroom apartment.



Going up with the elevator, you reach the ground floor of the main house with a large living room, an open plan kitchen and a bedroom with an en-suite bathroom and a guest toilet. Furthermore, on the upper floor there are 3 more bedrooms and bathrooms.

Furthermore, outside, there are several open and covered terraces and 2 swimming pools.

This luxury villa with panoramic sea views in Maryvilla has only high quality materials!

670M² BUILT

1,000M² PLOT

6 ROOMS

4 BATHROOMS

SEA VIEWS

SWIMMING POOL

GARDEN

TERRACE

GARAGE

STORAGE ROOM

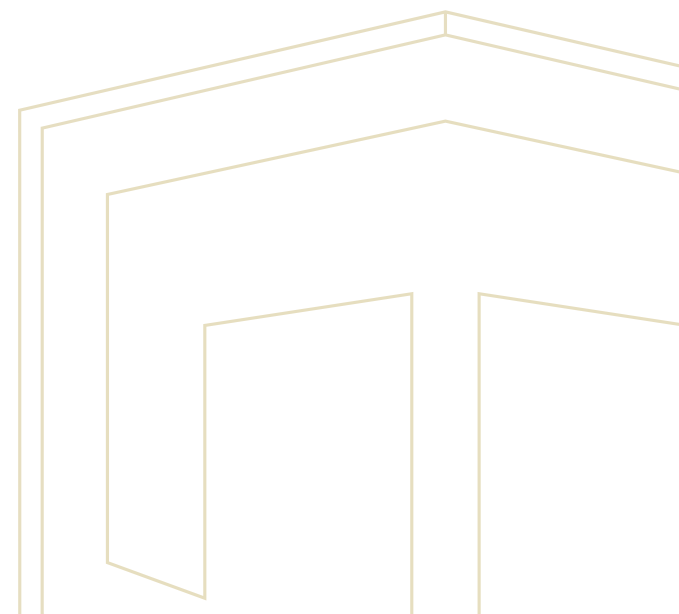



MORAGUESPONS
MEDITERRANEAN HOUSES



MORAGUESPONS
MEDITERRANEAN HOUSES



MORAGUESPONS
MEDITERRANEAN HOUSES



MORAGUESPONS
MEDITERRANEAN HOUSES



MORAGUESPONS
MEDITERRANEAN HOUSES



MORAGUESPONS
MEDITERRANEAN HOUSES

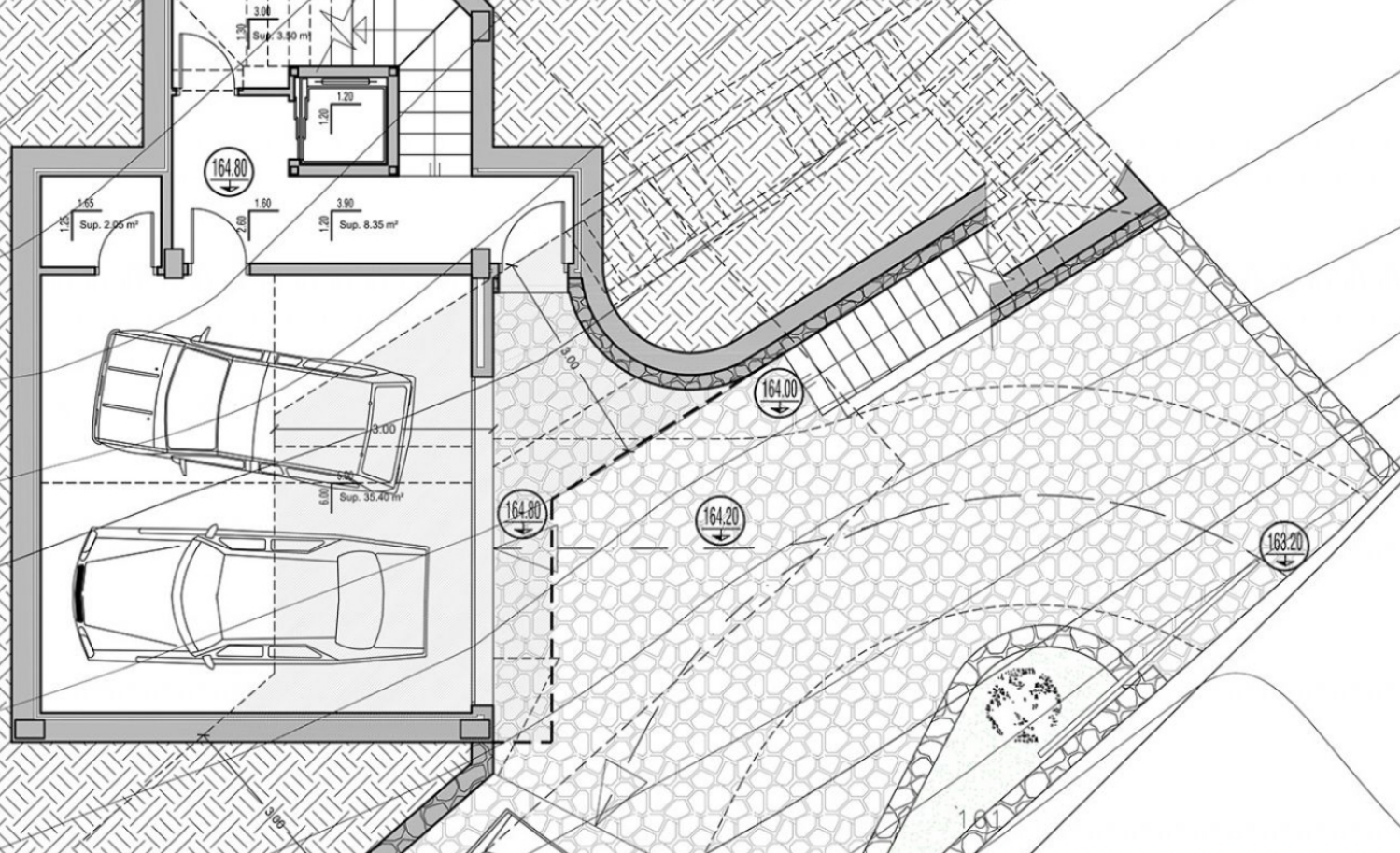

| | | | | |
|--------------|----------------------------|----------------------------|----------------------------|---------------------------|
| Sotano | 76.10 m ² | 51.10 m ² | * 25.00 m ² | * 0.00 m ² |
| TOTAL | 76.10 m² | 51.10 m² | 25.00 m² | 0.00 m² |

* Se descuentan los 25 m² primeros, no computando edificabilidad pero sí ocupación.

PROYECTO BÁSICO Y DE EJECUCIÓN.

Ref. B+E01-18

escala

1:50

MORAGUESPONS
MEDITERRANEAN HOUSES

plano.

DISTRIBUCION NIVEL 0

hoja.

5.



MORAGUESPONS
MEDITERRANEAN HOUSES

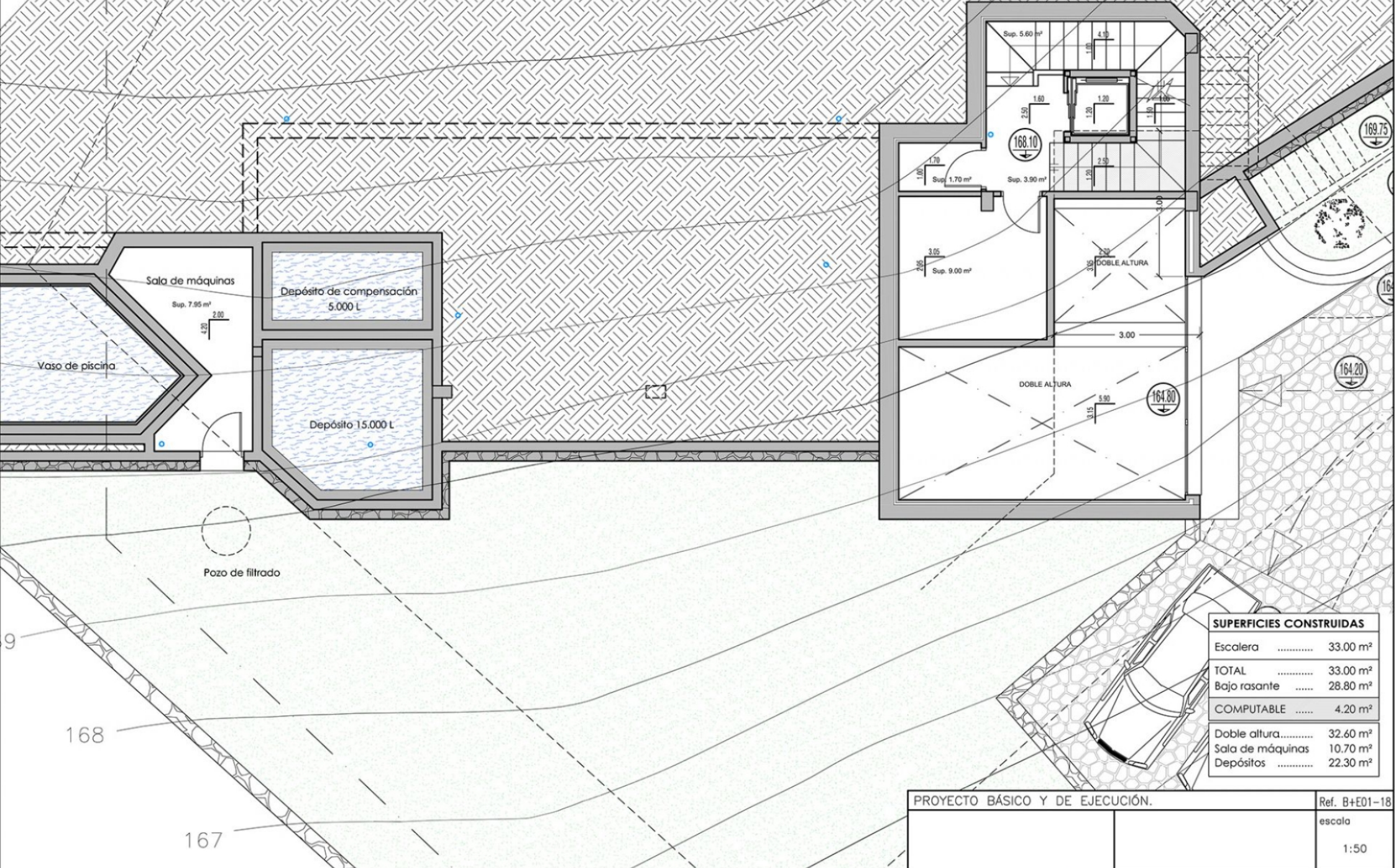

| SUPERFICIES CONSTRUIDAS | |
|-------------------------|----------|
| Escalera | 33.00 m² |
| TOTAL | 33.00 m² |
| Bajo rasante | 28.80 m² |
| COMPUTABLE | 4.20 m² |
| Doble altura..... | 32.60 m² |
| Sala de máquinas | 10.70 m² |
| Depósitos | 22.30 m² |

| | | |
|---------------------------------|--|---------------|
| PROYECTO BÁSICO Y DE EJECUCIÓN. | | Ref. B+E01-18 |
| | | escala |
| | | 1:50 |

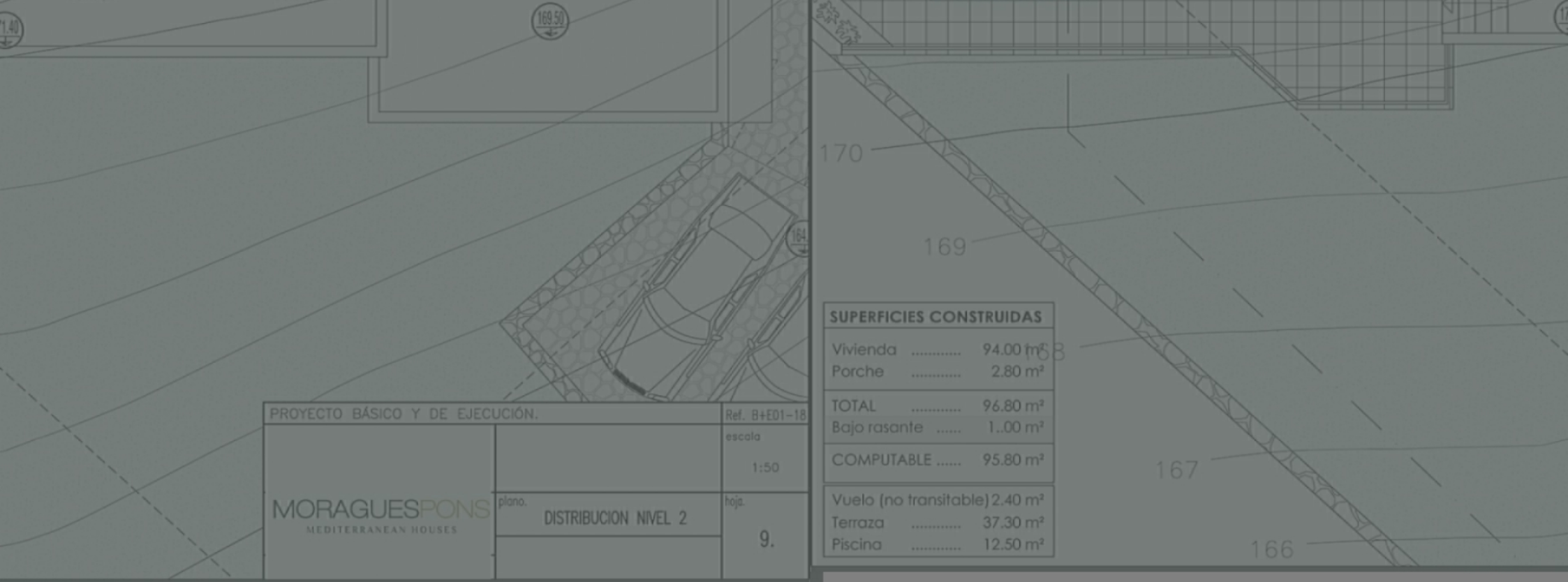

| | | |
|--------------------------------------|----------------------|---------------|
| PROYECTO BÁSICO Y DE EJECUCIÓN. | | Ref. B+ED1-18 |
| MORAGUESPONS MEDITERRANEAN HOUSES | plano. | escala |
| | DISTRIBUCION NIVEL 2 | 1:50 |
| | | hoja. 9. |

| SUPERFICIES CONSTRUIDAS | |
|------------------------------|----------------------|
| Vivienda | 94.00 m ² |
| Porche | 2.80 m ² |
| TOTAL | 96.80 m ² |
| Bajo rasante | 1.00 m ² |
| COMPUTABLE | 95.80 m ² |
| Vuelo (no transitable) | 2.40 m ² |
| Terraza | 37.30 m ² |
| Piscina | 12.50 m ² |



C/ Avda. Ausias March 13, Local 4,
03730 Jávea, Alicante, Spain

+34 96 579 39 42
+34 634 067 549

info@moraguespons.es
www.moraguespons.es

M-F: 10:00-18:00
S: 10:00-14:00

