



PONS

Newly built ground floor flat for sale in Jávea
OLD TOWN CENTER, JÁVEA/XÀBIA - REF. TIME 11



MORAGUESPONS
MEDITERRANEAN HOUSES

Construction work is expected to start in October 2024, with an estimated construction period of 20 months, after which the plots will be notarised at the notary. This means that you will be able to enjoy your future home in Jávea in June 2026;



The structural qualities inside the houses include flooring made of rectified stone-effect porcelain stoneware throughout the house, exterior joinery made of lacquered aluminium with thermal bridge interruption. Motorised aluminium blinds in the living rooms and bedrooms. Reinforced entrance door. Kitchen units in white laminate with concealed handle, upper and lower units, aluminium skirting board, worktop and front in compact quartz. Induction hob, multifunction oven, microwave, first brand integrated filter group and dishwasher. Reinforced and white lacquered access door to the flat as well as the interior doors, rectified tiles in white ceramic material or in a soft colour, mirror up to the ceiling on the skirting board. Composite resin washbasin. Composite resin showers, thermostatic taps and glass enclosure. Water heating by aerothermal heating, air conditioning with ducting, video intercom, Legrand home automation system.

Hybrid system consisting of air supply via the façade and forced extraction with individual extractors for each flat.

Please feel free to contact us for further information.

€ 295,000

98M² BUILT

2 ROOMS

2 BATHROOMS

SWIMMING POOL

GARDEN

TERRACE

GARAGE

STORAGE ROOM

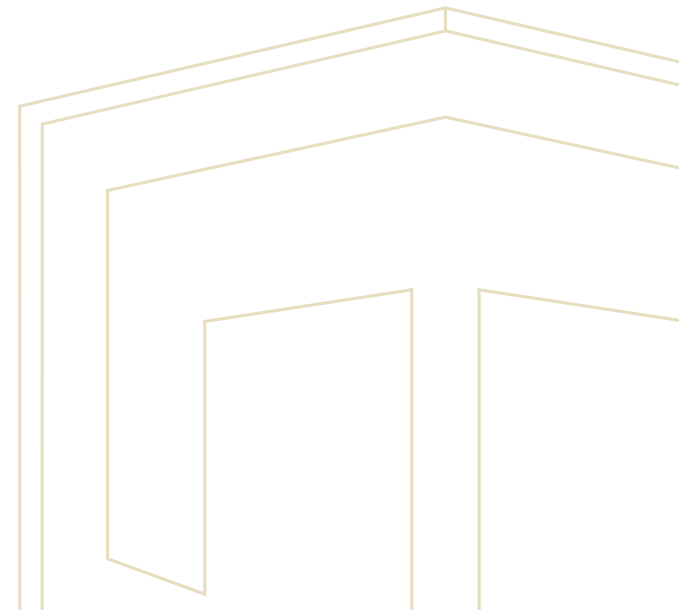



MORAGUES



MORAGUESPONS
MEDITERRANEAN HOUSES



MORAGUES PONS



MORAGUES PONS
MEDITERRANEAN HOUSES



MORAGUESPONS



MORAGUESPONS
MEDITERRANEAN HOUSES



MORAGUESPONS



MORAGUESPONS
MEDITERRANEAN HOUSES



MORAGUESPONS



MORAGUESPONS
MEDITERRANEAN HOUSES





MORAGUESPONS
MEDITERRANEAN HOUSES

C/ José de Espronceda nº 12
Jávea



Ubicación de la vivienda
Housing location

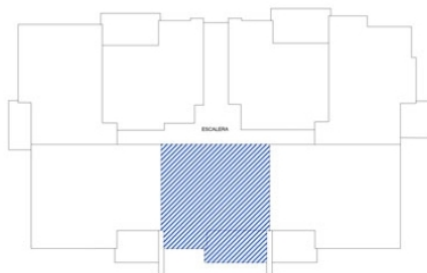

CUADRO DE SUPERFICIES TABLE OF AREAS

Superficie Útil Vivienda + Terraza Useful Area + Terrace	88,63 m²
Superficie Construida Vivienda + Terraza Building Plot Area + Terrace	97,65 m²
Superficie Construida + Comunes Building Plot Area + Common Spaces	89,16 m²
HD Hall acceso - Distribuidor / Access Hall	7,27 m²
EC Estar/ Comedor / Living, Dining Room	19,27 m²
C Cocina / Kitchen	8,22 m²
DP Dormitorio Principal / Master Bedroom	13,82 m²
D2 Dormitorio 2 / Bedroom 2	12,13 m²
B1 Baño 1 / Bathroom 1	4,68 m²
B2 Baño 2 / Bathroom 2	4,92 m²
TD Terraza Descubierta / Open Terrace	16,71 m²
LVD Lavadero / Laundry	1,61 m²



Vivienda / House: **11**

Planta / Floor: **PRIMERA PLANTA**
FIRST FLOOR

Escala / Scale: 0 1 2 3 4 5 m

*El presente plano no es definitivo, ya que ha sido elaborado conforme al Proyecto Básico del Edificio y, por tanto, TIMELESS PROPERTIES se reserva la facultad de incluir las modificaciones necesarias por exigencias técnicas y/o jurídicas u ordenadas por cualesquiera administraciones u organismo públicos, ajustándolos en todo



MORAGUESPONS
MEDITERRANEAN HOUSES



C/ Avda. Ausias March 13, Local 4,
03730 Jávea, Alicante, Spain

+34 96 579 39 42
+34 634 067 549

info@moraguespons.es
www.moraguespons.es

M-F: 10:00-18:00
S: 10:00-14:00

